

SXT®
SCOOTERS

CAREON by  electisan

Manual

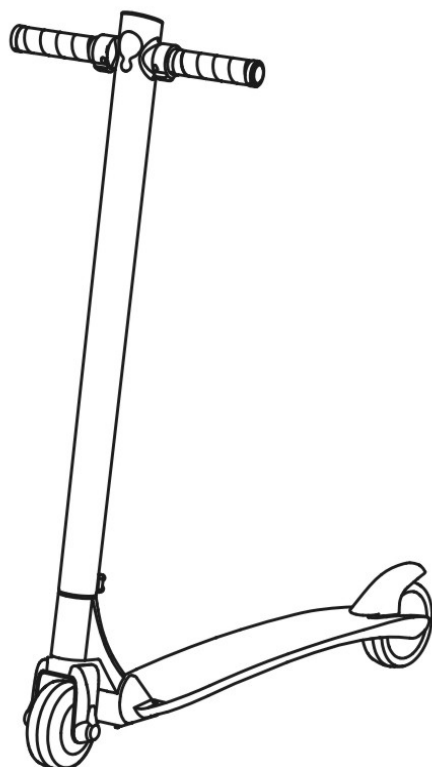



Contents

1. About ET Mini Carbon Fiber Smart Scooter

1.1 Product Introduction

1.2 Product and Parts

1.3 Product Parameter

2. Product Use

2.1 Schematic for Product

2.2 Entire Scooter Assembling

2.3 Smart Application for ET Mini Carbon
Fiber Smart Scooter

2.4 Riding Experience

2.5 Quick Fold

2.6 Scooter Charging

2.7 Cruise Control

2.8 Scooter Body Sway Adjustment

3. Service and Maintenance

3.1 Routine Instructions

3.2 Charging Instructions

3.3 Battery Instructions

4. Quality Assurance

5. After-Sales Service

1. About ET Mini Carbon Fiber Smart Scooter

1.1 Product Introduction

Thank you for your selection of ET mini carbon fiber smart scooter (Hereinafter called “ET mini”). ET mini is available in three models listed below. It is a fashionable, portable, leisure device which is ideal for a short commute whether it be for city commutes or scholar travels. It has a novel appearance, quick folding system and is portable and easy to carry.

We are sure you will have fun riding the scooter from here!

1.2 Product and Parts

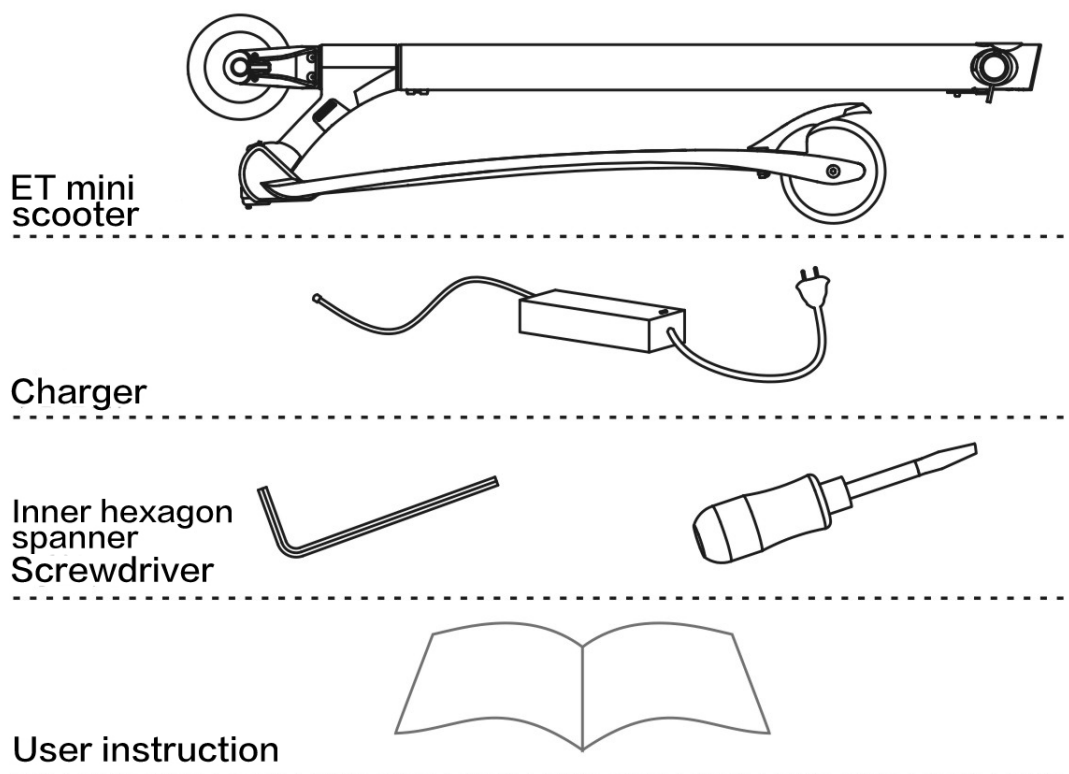

1.3 Product Parameter

ET mini	Basic version	Fashionable (S)	Deluxe (Pro)
Endurance mileage	25km	30km	40km
Speed	10km/h–22km/h	10km/h–25km/h	10km/h–28km/h
Scooter weight	7kg	7.2kg	7.5kg
Battery specification	240Wh	270Wh	315 wh (LG battery)
Color	Black/white	Black/white /red/blue/green	Black/white /red/blue/green
Scooter dimension	950 x 380 x 1040mm		
Cruise control	Automatically starts after 5 s travel at a constant		
Smart APP	Electisan™ 1.0		
Brake	electro–magnetic brake + mechanical brake		
CPU	FOC Vector CPU		
Tyre	5 in. solid rubber tyre		
Charging time	3-5 h		
Motor	36 V 250 W brushless permanent magnet motor		

2. Product Use

2.1 Schematic for Product

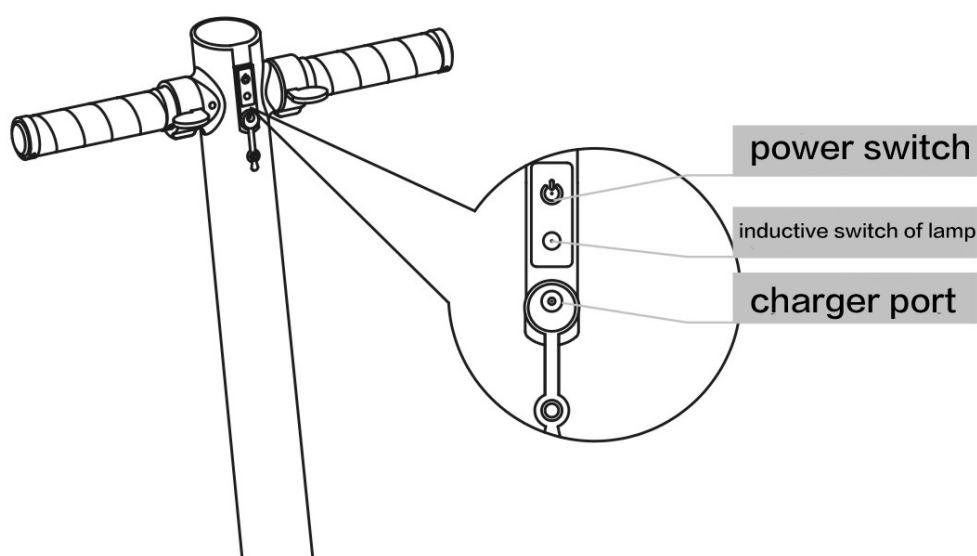
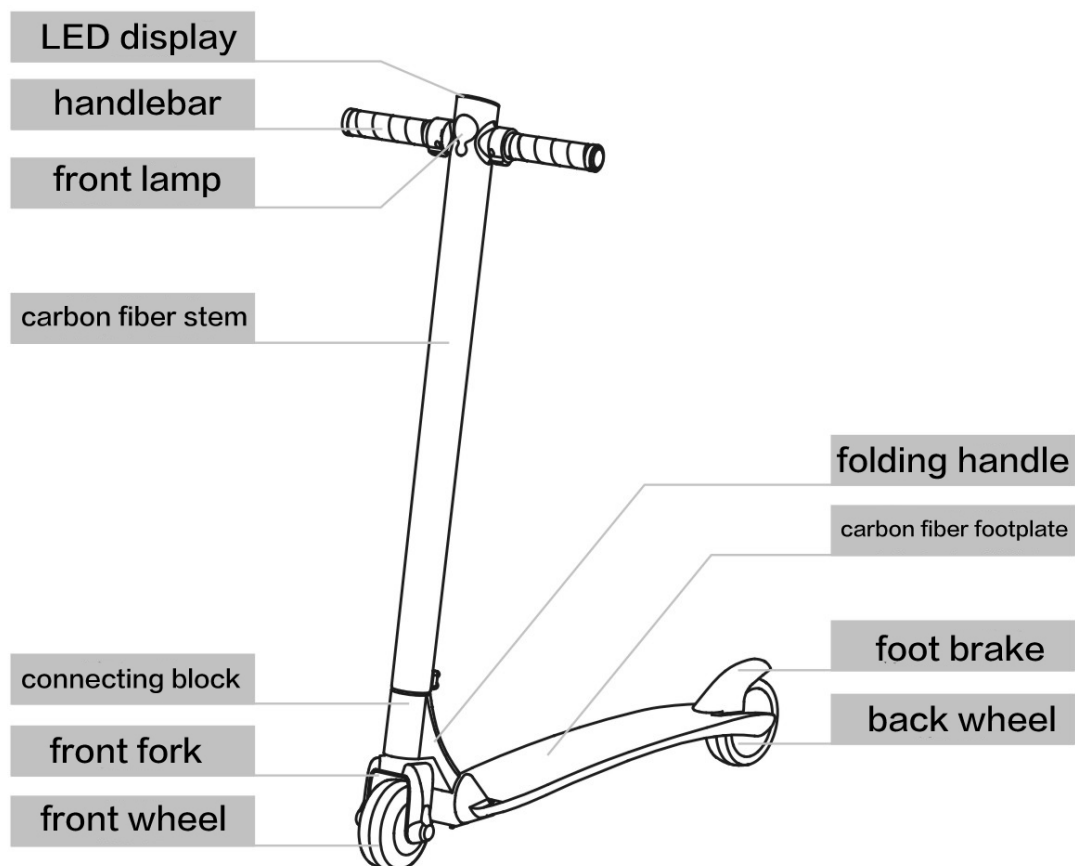

2.2 Entire Scooter Assembling

1. Place the scooter stably on the ground and turn on the folding switch first as shown below.

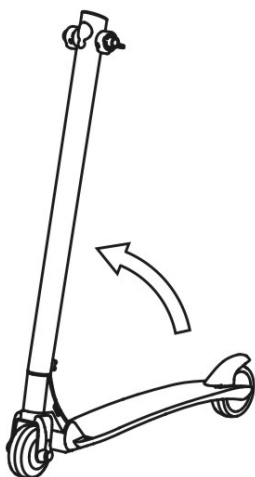
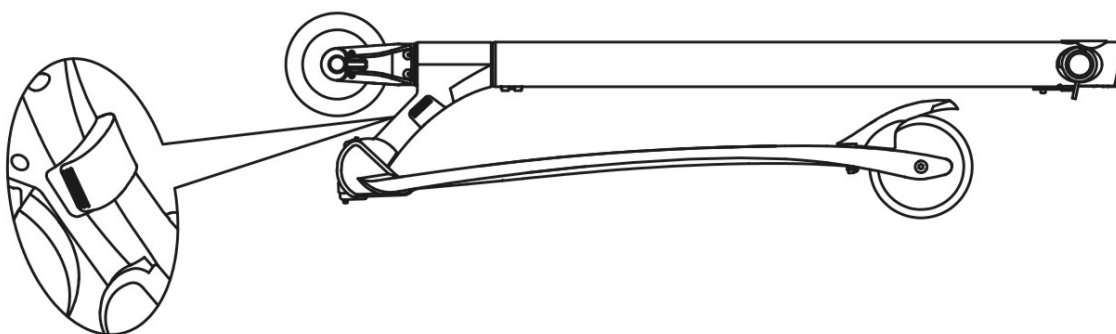

2. Hold the stem by hand and pull it up until it is vertical to the ground and you hear a click. The click means the switch is reset.

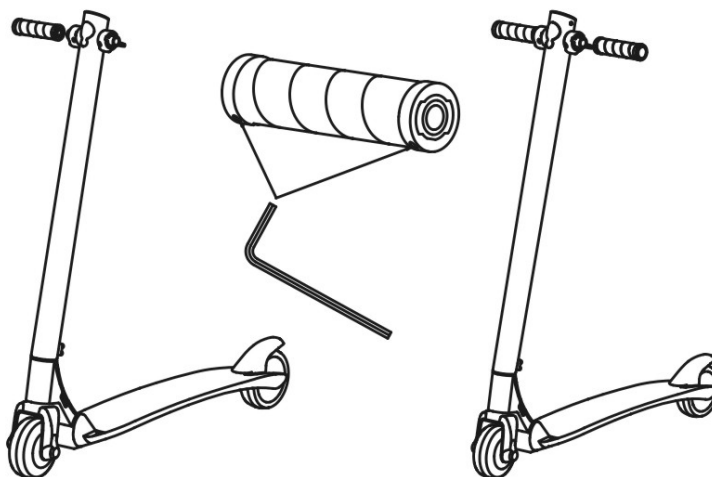

3. Tighten the handlebar clockwise, and tighten two nuts in the left and right handlebars with a 3 mm inner hexagon spanner as shown below.

After installation, test the start/stop.

Each ET mini-scooter has the factory default gear 11. If you want to experience the scooter in more gear modes, please download the electisan™ Mobile client to adjust the gear.

2.3 Smart APP for ET mini

You will require smart mobile phone with either Android or iOS to upload and install the electisan™ Mobile client APP. Search electisan™ in application store or APP Store or scan the two dimensional code to download APP.



1. Download and install App and sign/log in.



2. After start-up, the blue-tooth icon on the display will continuously flash as shown in Interface 1; press the start key again to enter Interface 2, which means “wait for connection” .

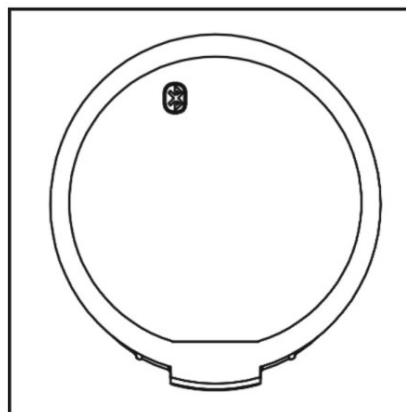

Interface 1

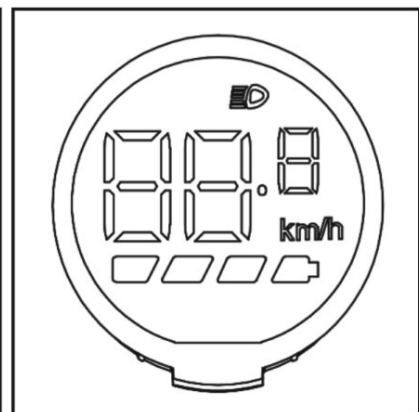

Interface 2

3. Click on the “equipment search” button to connect ET mini; after a successful connection, you can hear a tick. At this time, the bluetooth icon on the display will always light up.

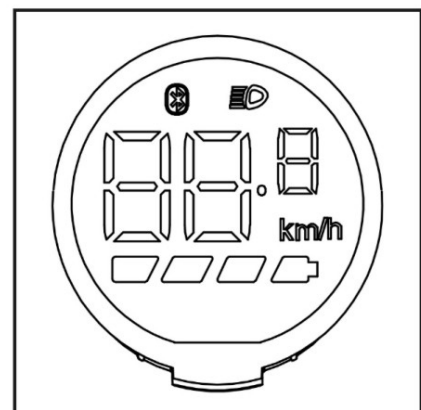

4. Enter the phone

Interface 1: Speed adjustment, gear shift, and unlocking

Interface 2: Scooter information

Interface 3: Equipment setting



Interface 1



Interface 2



Interface 3

2.4 Riding Experience

To adapt to this scooter as soon as possible, you should ride it for the first time in an open, unobstructed place. Before riding it, you need to check if every part works normally. When you turn on the power switch, the panel lights up, and you can ride it; when you slowly press the right twist grip to control a constant speed, ensure no abnormal sound or blockage occurs from the scooter during its travel; to brake the scooter, press the left electro-magnetic brake and check it works freely, likewise with the foot brake on the rear wheel; if everything is normal, you can continue to securely use this scooter.

2.5 Quick Fold

1. Open the folded cover and hold the stem to press the scooter down and fold the entire scooter as shown below

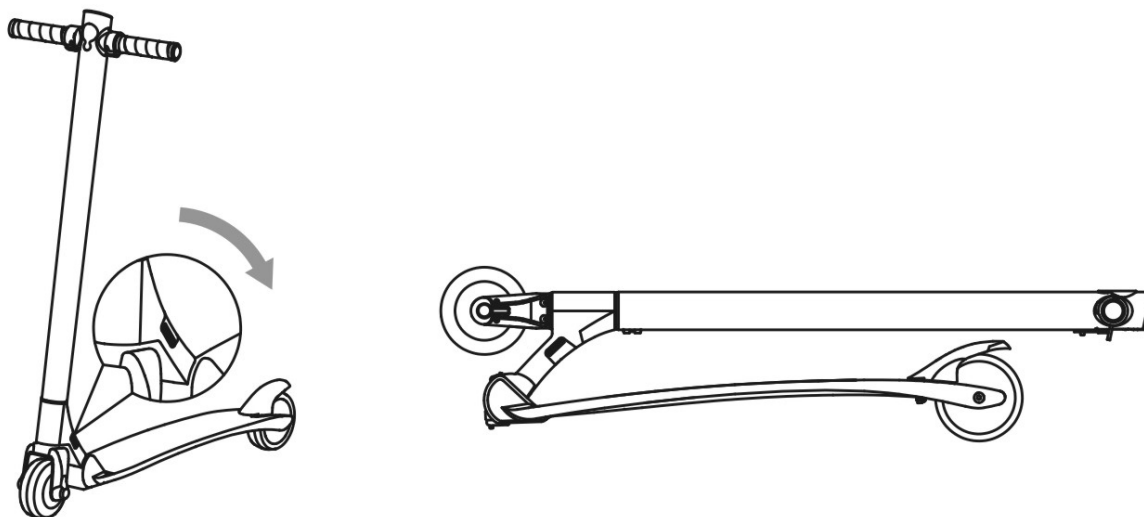

2.6 Scooter Charging

1. When the input and output of the charger are connected, its red indicator comes on. The battery is full when the indicator light turns from red to green. At this time you can remove the charger and place the protective cover back.

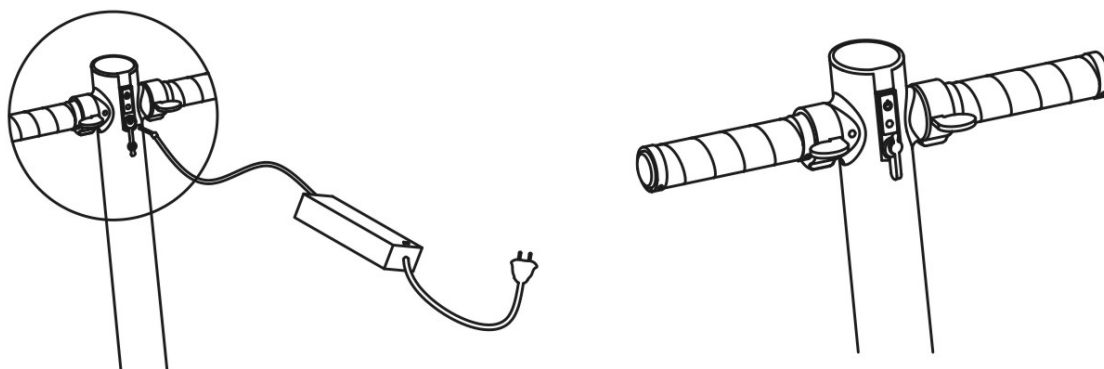

2. Standard Charging Time:

The scooter is charged for the specified period of time, about 3–5 hours, for the associated charger at ambient temperature between -10°C and 50°C . he protective cover back.

3. This charger has an over charge protector, which will be damaged by large current input. The charging current must be less than 2A. Long-term charging at big current can damage the battery and hinder the lifespan of the battery.

2.7 Cruise Control

The cruise control can keep the scooter traveling at a constant speed without continuous turning of the throttle twist grip. To Activate Cruise control: press the throttle twist grip for 5–6 s during travel to start the cruise control. To De-activate Cruise control (Stop) : turn the electro-magnetic brake to stop the cruise control.

2.8 Scooter Body Sway Adjustment

Each folded scooter has a gap. If the folding part sways during use of the scooter, please adjust the screw in it with a slotted screwdriver. Do not tighten the screw too heavily, or the folding pin will be stuck.

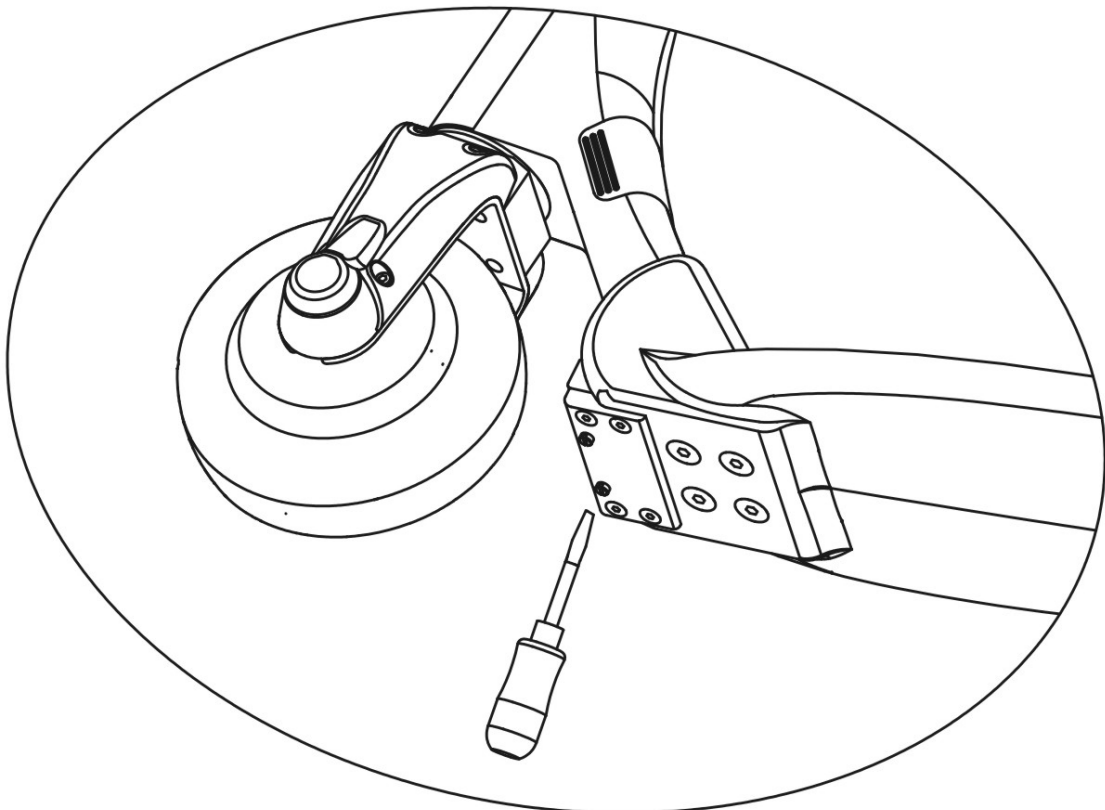

3. Service and Maintenance

3.1 Routine Instructions

1. Please use this scooter in a correct manner. To ride it safely, please wear personal protective equipment (including helmet, elbow, knee shield, etc.).
 2. Cleaning– use a soft rag on the scooter surface. Do not rinse it with water.
 3. Please slow down the scooter before travelling on a downward slope.
 4. Please do not use this scooter in rain, snow or through water, etc.
 5. Please do not use aftermarket parts like charger and other components not supplied by this company in order to avoid fault and incident.
 6. Do not tamper with this scooter. If the scooter is faulty, please contact local vendor or after–sales service office in time.
 7. Do not use this scooter in the area where no entry is allowed in all the national/local laws and by relevant units.
 8. Do not use this scooter in the place having risks or not meeting the product use requirements, such as deep pit, cracks, water pit with the depth of more than 3 cm, very uneven road, etc.
 9. Do not ride ET mini across steps or stairs. Do not jump or ramp ET mini in any case, for example, across a ridge.
 10. Do not allow any child under 14 and any old man above 65 to solely ride this scooter unless otherwise they are accompanied by their family member(s).
 11. Do not allow any pregnant woman, drunk man, mental disease patient, heart attack patient and limited active ability person to ride the scooter.
- This company will claim no responsibility for any fault or incident resulting from use of this scooter in breach of the above specification.
-

3.2 Charging Instructions

1. Please place the safety cover back after the scooter when fully charged.
2. Please place the scooter out of reach of children during charging.
3. Please do not use any other brand or type of charger to charge this scooter. In addition, this charger is not suitable for charging other types of scooter or battery.
4. Please do not disassemble any faulty charger. Please contact local vendor or after–sales service office in time.
5. Please charge the scooter indoors in a dry and well–ventilated place.
6. In case of odor or high temperature during charging, please stop charging immediately and contact local vendor or after–sales service office in time.

3.3 Battery Instructions

3.3 Battery Instructions

1. Please place the battery far from a fire or corrosive environment because it is flammable and explosive.
2. Please do not smear or remove the label from the battery case.
3. Please do not open the battery case to avoid the damage to the internal parts and contact local vendor or after-sales service office in time if the battery can not be charged.
4. In case of long-term disuse of this scooter, please charge the scooter periodically, i.e. every 20–30 days, to keep the battery in good conditions.

4. Quality Assurance

Thank you for your purchase of the product from this company.
Please observe the following regulations carefully to enjoy your benefit:

Please note that no quality assurance will be provided in case of one of the followings:

1. The quality assurance period has expired.
2. The scooter fails because of misuse, lack of maintenance and adjustment in breach of the use instructions.
3. The scooter is damaged due to improper use and storage or incident.
4. The scooter is damaged because the user tampers with it, or its fault can not be technically identified and analyzed because the user disassembles it to change its original fault state.
5. The scooter fails because the user does not use the original charger.
6. The data on the item without effective invoice do not comply with the information.
7. The scooter is damaged because of its contact with smoke, drug, chemical, water, etc.
8. The electronic system of the entire scooter is damaged by moisture, rain, snow, etc.
9. The scooter is damaged by act of God, including, but not only limited to flood, fire, lightning, earthquake, social event, etc.
10. Consumables are not covered. Examples listed but not limited to lamp, display, brake disc, tyre, rubber part, plastic part, etc.
11. The user is not satisfied with the scooter color, dimension, etc.

Scope of Quality Assurance

Part Name		Quality Assurance Period	Fault
Motor	Brushless motor	12 months	Impossible repair because of phase lack and burning of winding; magnetic leakage from magnet steel, drop-out, wheel axle deformation, etc., except from water entry to the motor. Hall and bearings have the quality assurance period of 6 months. In case of quality defect, they will be replaced in the first six months and repaired in the second 6 months.
Battery	Lithium battery	12 months	No quality assurance will be provided battery damaged by artificial factor, such as use of non-designated charger, etc. (No quality assurance will be provided for battery shell). The battery is cyclically repaired. No quality assurance period is prolonged for the replaced battery. The quality assurance period is a combined quality assurance period. The battery to which quality defect happens within 3 months is replaced and after 3 months replaced, with the accumulative quality assurance period of 12 months. (If the battery has the capacity below 65% of the standard capacity in the quality assurance period, it is replaced with a maintenance battery with the capacity not lower than 85% of standard capacity.)
Electrical part	Charger	12 months	No surface crack resulting from external force; assembling, label removal or smearing; short circuiting, breaking, etc. with complete wire;
	circuit board	12 months	Quality assurance will be provided for qualify defective except from assembling.
	Power failure protective brush handle	6 months	No damaged surface, no broken wire, loss of power failure protection, etc.
Member	Frame/handlebar	12 months	Quality assurance will be provided in case of loose weld or breakage except from external impact artificial damage.
	Wheel rim	6 months	Natural cracking, breakage and causeless deformation except from artificial deformation.



SXT SCOOTERS
BAHNHOFSTR. 1B
LÖRRACH 79539
TEL: +49 (0)7621- 916 148 0
EMAIL: INFO@SXT-SCOOTERS.DE
WEB: WWW.SXT-SCOOTERS.DE